

ADEPTUS®

Assembly Instructions

77809 - 1 Drawer Tv Bench Natural Varnished

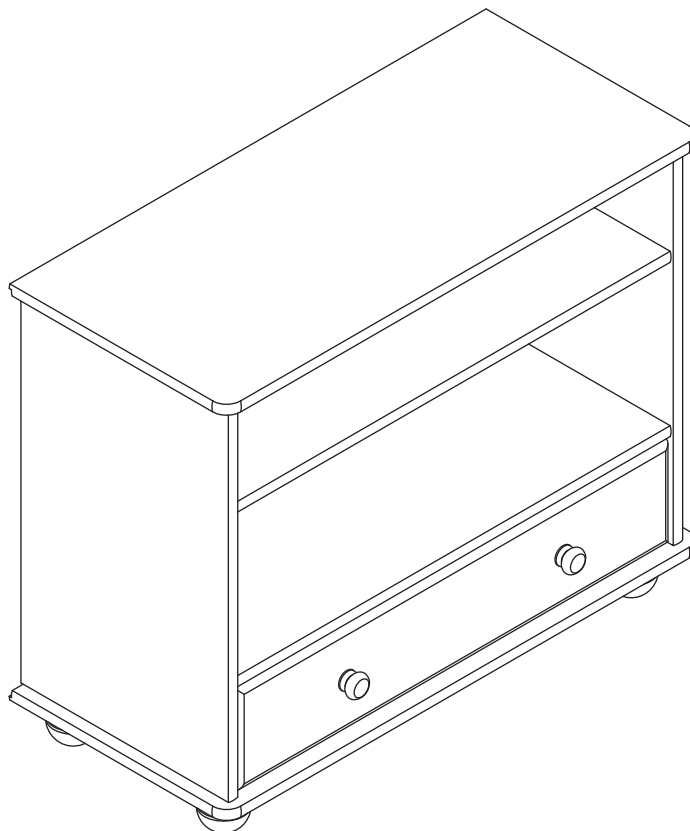

CUSTOMER SERVICE AND REPLACEMENT PARTS:

FOR FASTER SERVICE PLEASE GO TO OUR WEBSITE AT WWW.ADEPTUS.COM
OR CALL TOLL FREE 1.888.ADEPTUS (1.888.233.7887)
MON.-FRI. 10 A.M. TO 4 P.M. E.S.T., CLOSED HOLIDAYS

IF YOU CALL, PLEASE HAVE ON HAND:

1. PRODUCT NAME AND STOCK NUMBER
2. WHERE THE UNIT WAS PURCHASED
3. P.O. CODE ON THE BOTTOM OF THIS COVER PAGE OR DATE PURCHASED
4. BOX NUMBER, IF NOTED ON THE SIDE OF THE BOX

PLEASE LEAVE YOUR NAME AND NUMBER AND WE WILL DISCUSS ANY ISSUES ON OUR CALL BACK TO YOU.

HELPFUL OVERALL:

- SAVE INSTRUCTION SHEETS AND BOX UNTIL YOU ARE SATISFIED WITH THE ASSEMBLY.
- DO NOT GLUE PARTS WHEN ASSEMBLING THE UNIT, UNLESS YOU HAVE TESTED THE ASSEMBLY.
- PERFORM ASSEMBLY ON A CLEAN HARD SURFACE USING THE CARTON OR A TOWEL TO PROTECT THE SURFACE. DO NOT ASSEMBLE ON CARPET.

PLEASE VISIT WWW.ADEPTUS.COM TO REGISTER YOUR PRODUCT AND SEE THE COMPLETE ADEPTUS PRODUCT LINE.

THANK YOU FOR YOUR PURCHASE AND WELCOME TO ADEPTUS!

Many People, One Thought

PROVIDING QUALITY SOLID WOOD FURNITURE AT AN AFFORDABLE PRICE HAS BEEN A GROUP EFFORT. FROM CONCEPT TO PRODUCT DESIGN, MANUFACTURING AND RETAILING, EACH AREA FOCUSES ON THE DETAILS THAT WILL ASSURE YOU A LOW PRICE. BUT NEVER AT THE EXPENSE OF FUNCTION, STYLING, OR GOOD SENSE.

A "READY - TO - ASSEMBLE" ITEM REDUCES TRANSPORTATION AND WAREHOUSING COSTS WHICH HELP YOUR RETAILER KEEP THEIR PRICES REASONABLE. NOW, YOU ARE JOINING "TEAM ADEPTUS" WITH THE FINAL STEP, ASSEMBLY.

• YOU ASSEMBLE, YOU SAVE •

WELCOME TO ADEPTUS!

This is a SOLID WOOD product:

We inspect all wood, and follow guidelines to pass quality inspections. Solid wood furniture has knots, small cracks, and what may look like blemishes. These characteristics are a natural by product of producing furniture from natural material.

We take extra care with our drawer parts:

1. We use real wood drawers sides.
2. The drawer sides are not painted to help protect your clothes from chemical odors and residue.
3. Finely sanded drawer parts eliminate snags when storing your clothes.

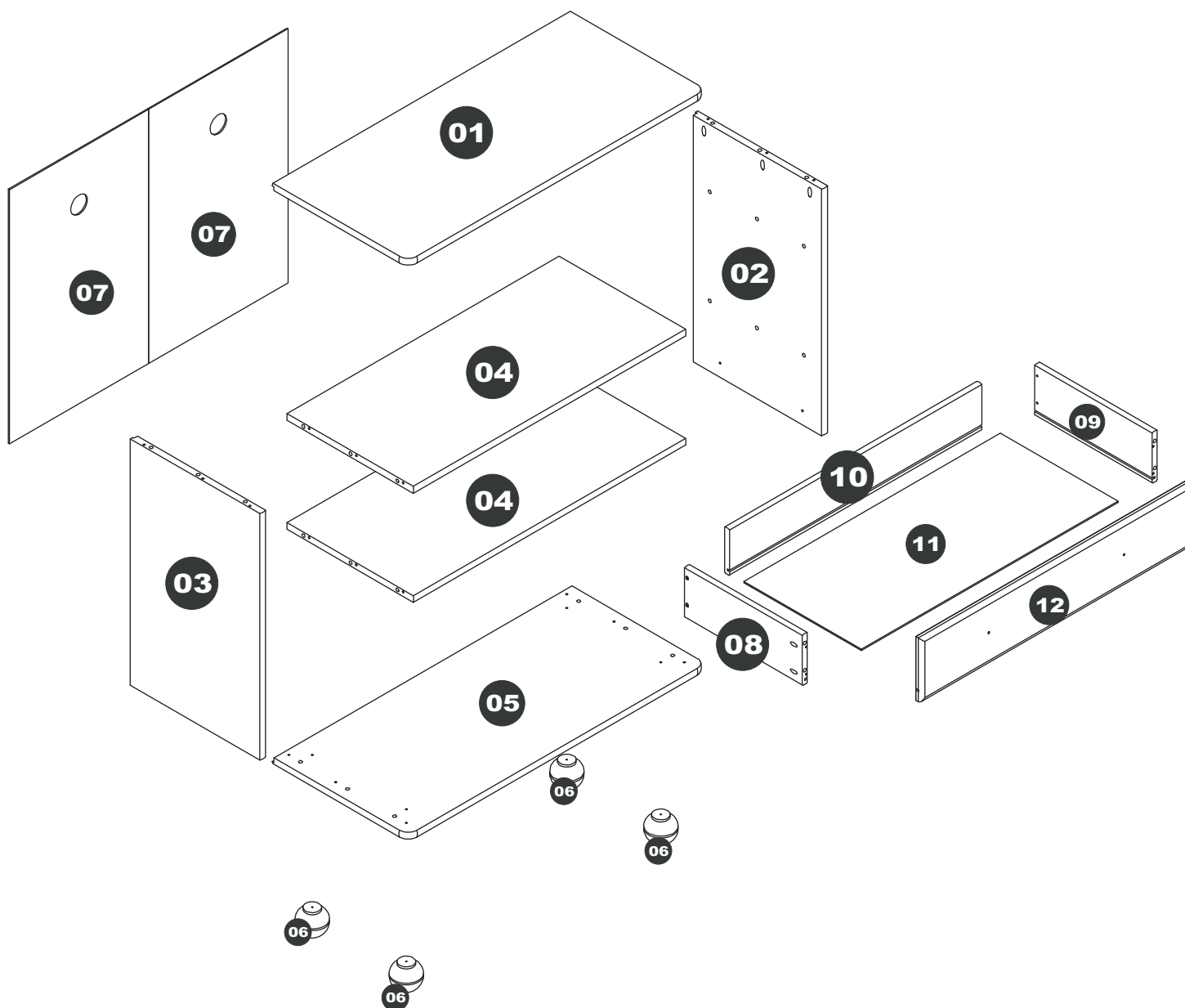

A=22 8,0 x 30mm	B=26 3,5 x 30mm	C=12 4,0 x 40mm	D=06 3,0x 16mm	E=04 6,0x 10mm
F=18 	G=01 LEFT SET	H=01 RIGHT SET	I=02 	

These tools are not supplied by the manufacturer
Ces outils ne sont pas fournis par le fabricant

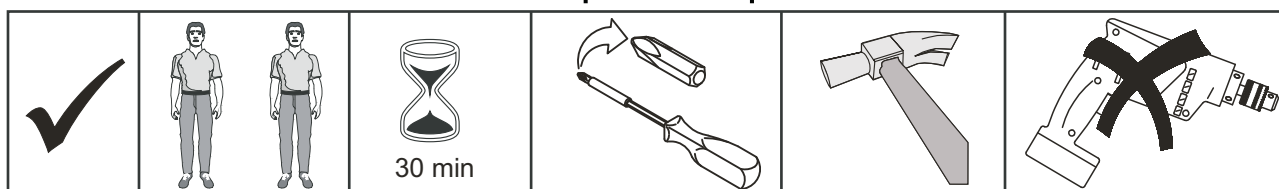

1

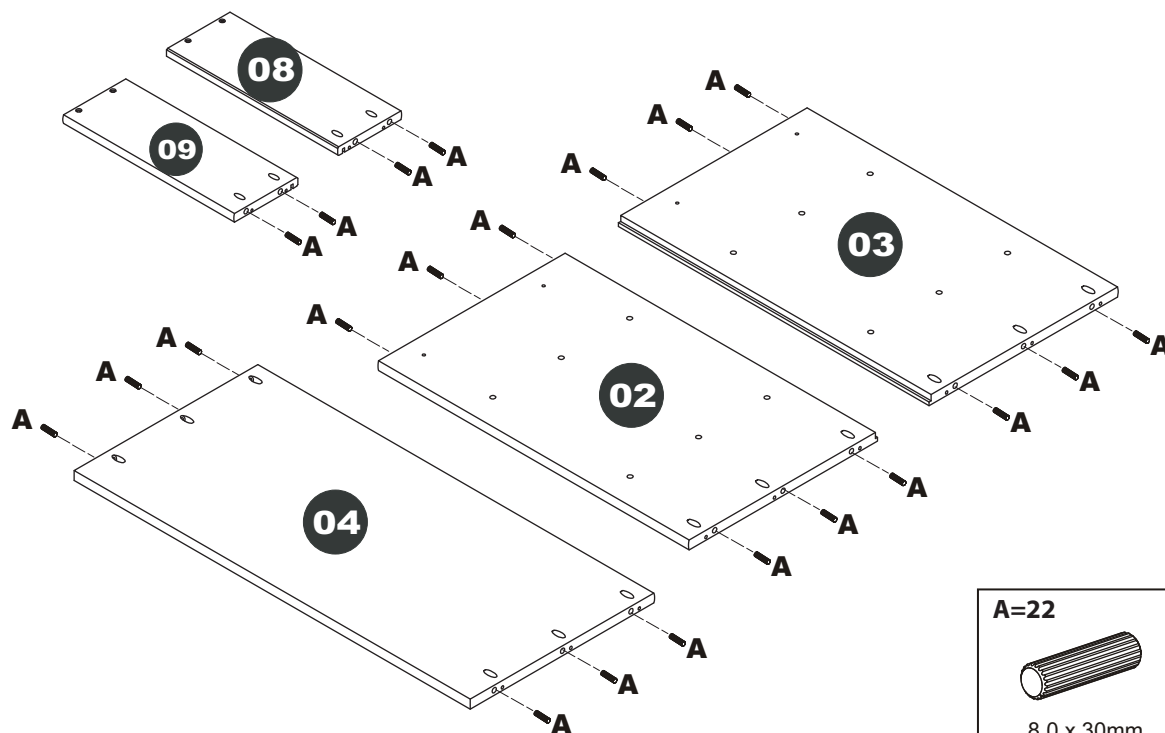

2

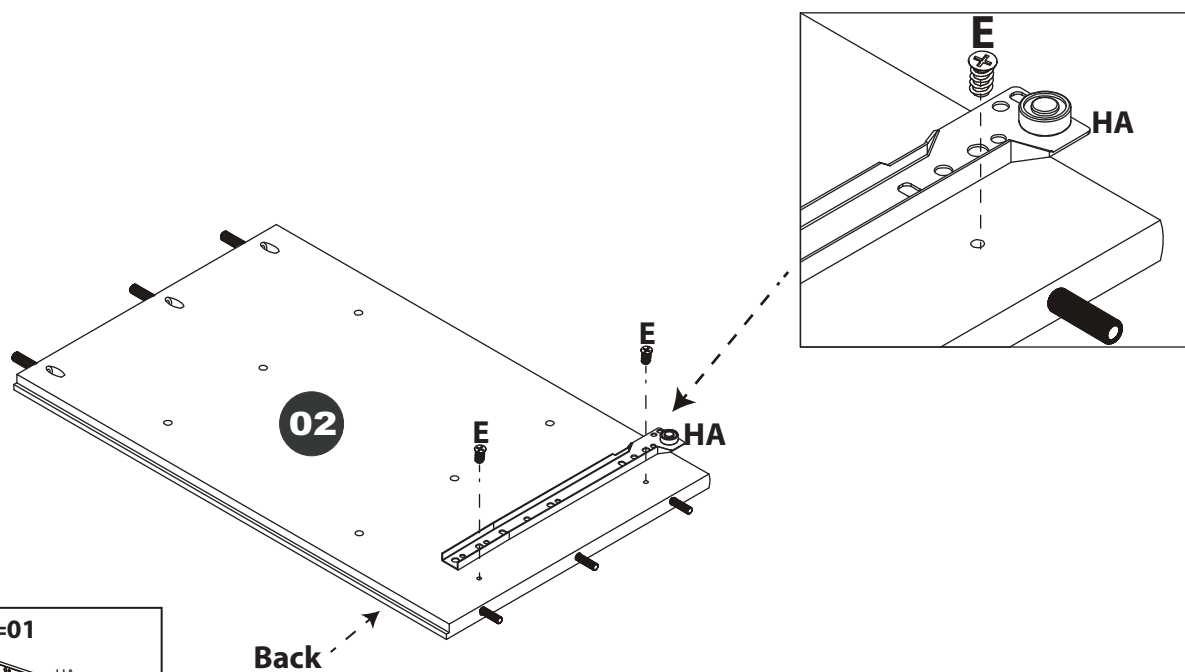

E=02



6,0x 10mm

H=01

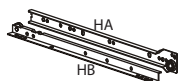

RIGHT SET

3

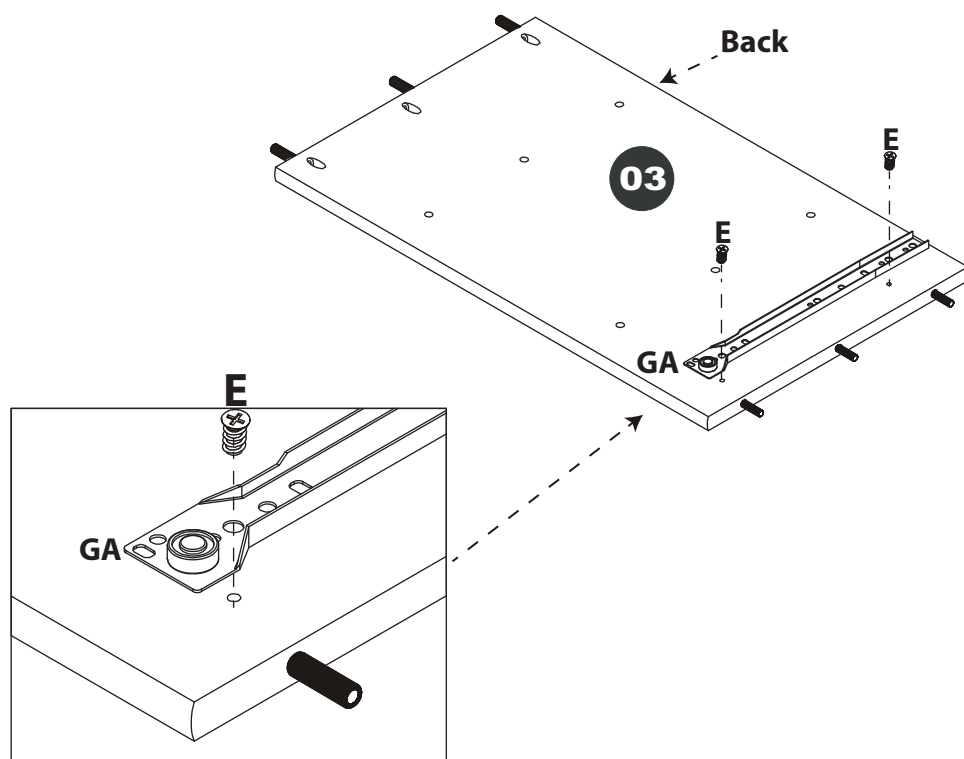

E=02



6,0x 10mm

G=01



LEFT SET

4

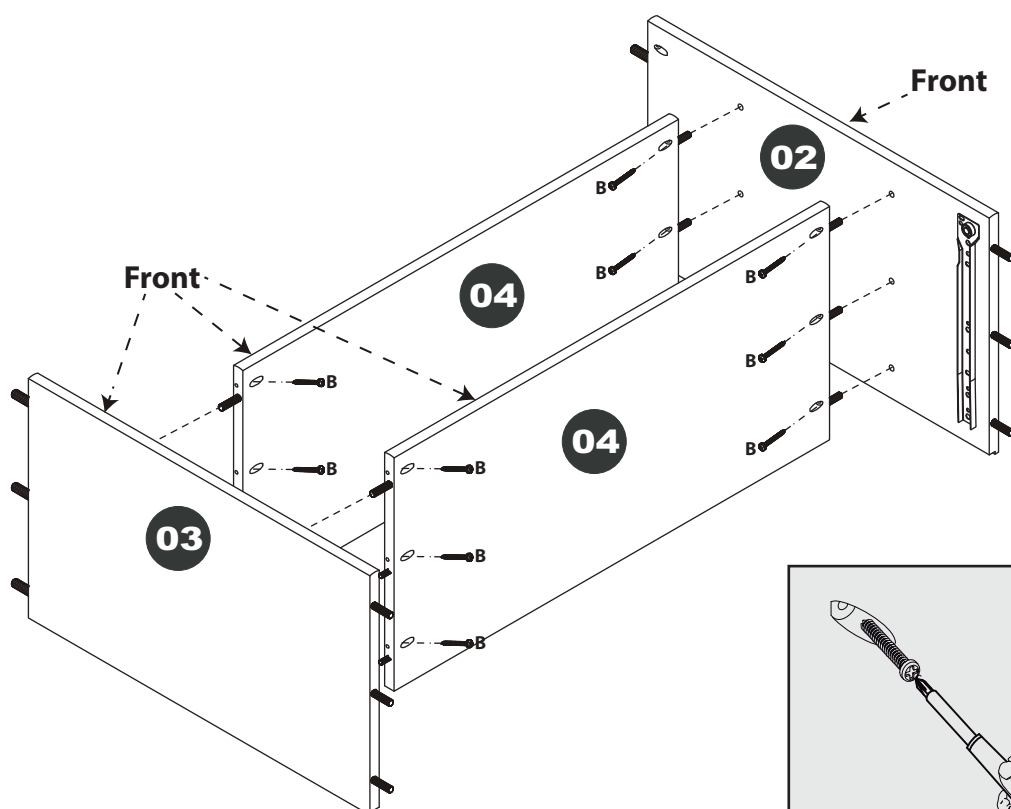

B=12



3,5 x 30mm

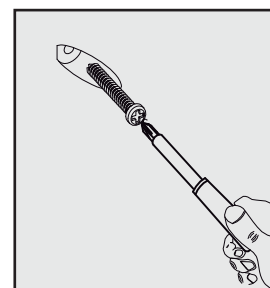

5

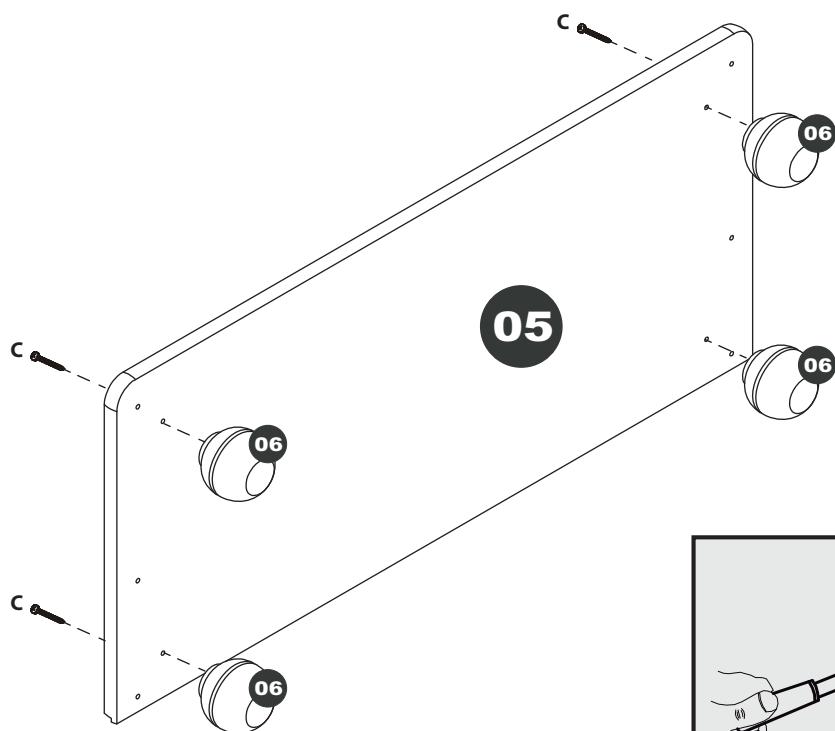

C=04

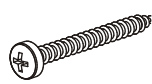

4,0 x 40mm

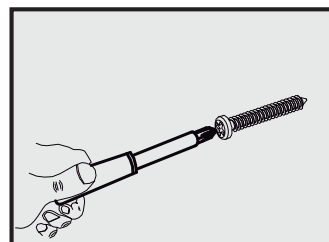

6

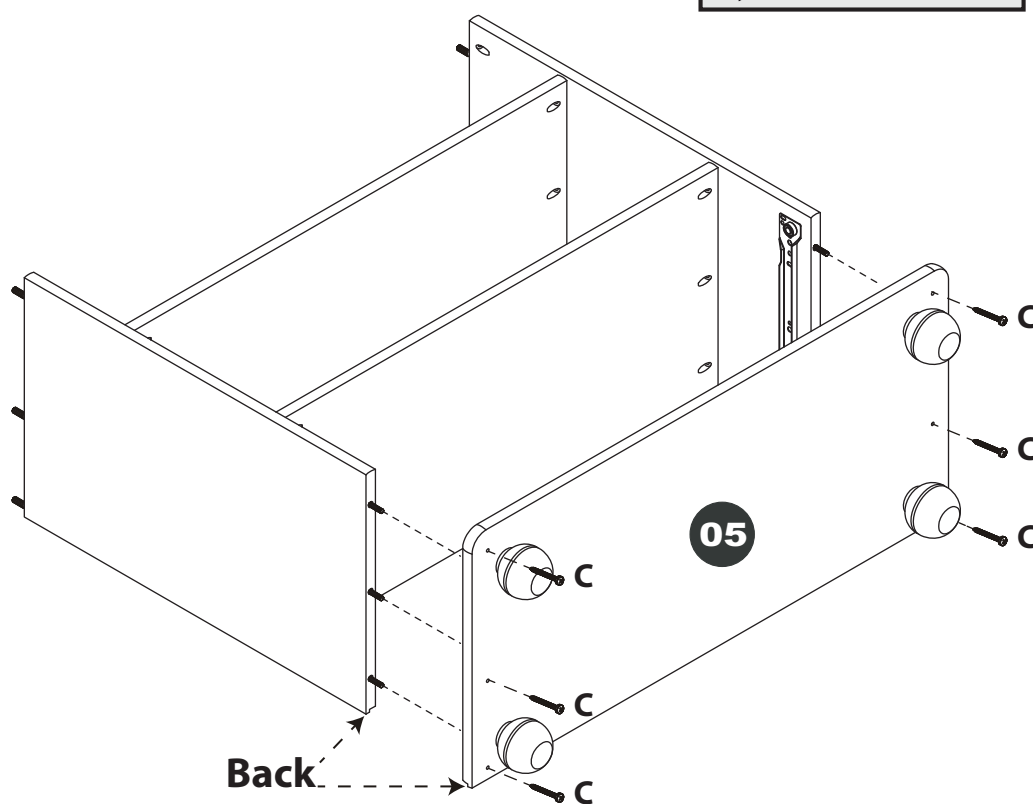

C=06

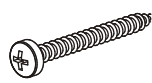

4,0 x 40mm

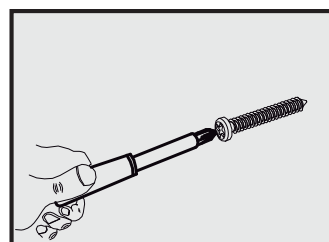

Back

7

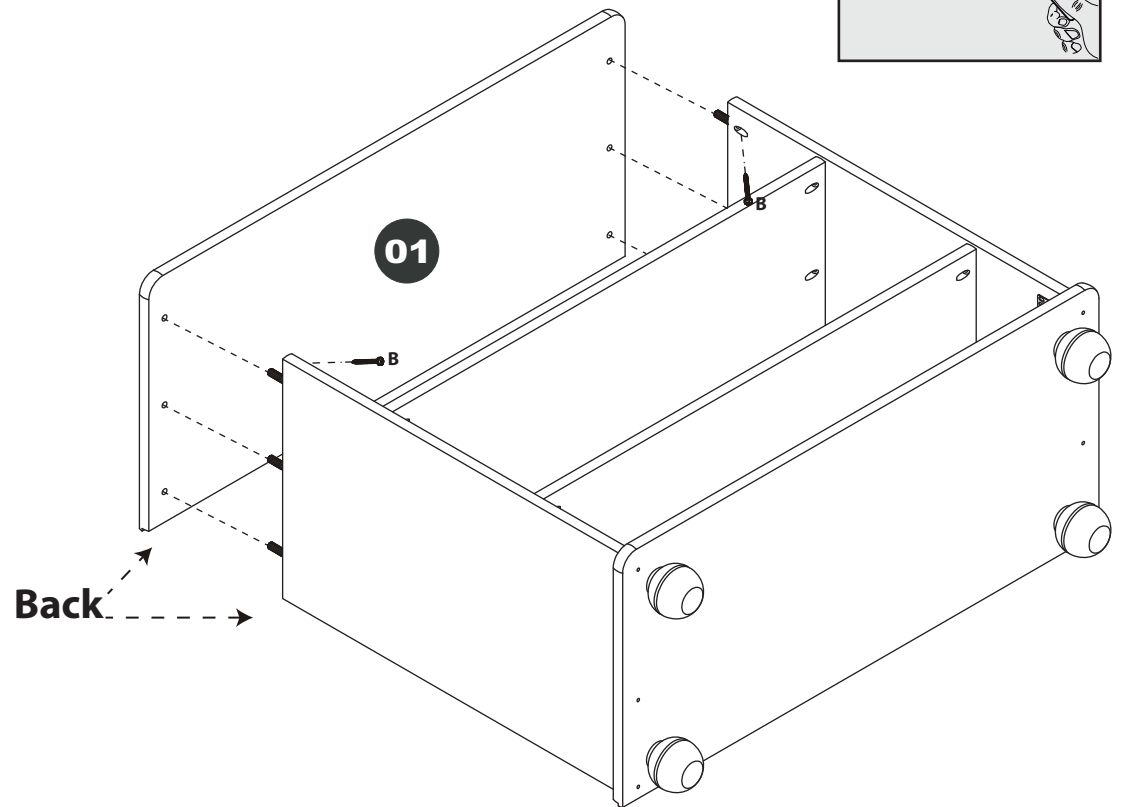
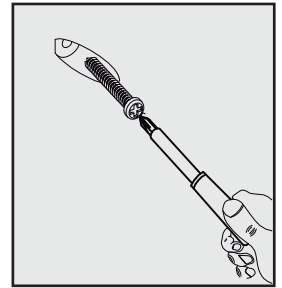

B=06



3,5 x 30mm

8

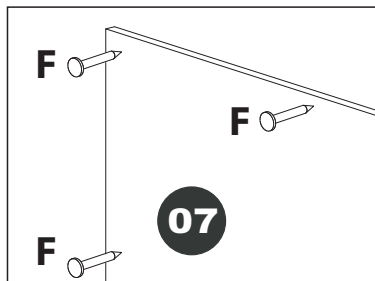

Use all back panels nails.
Evenly spaced, they help
make the unit strong.

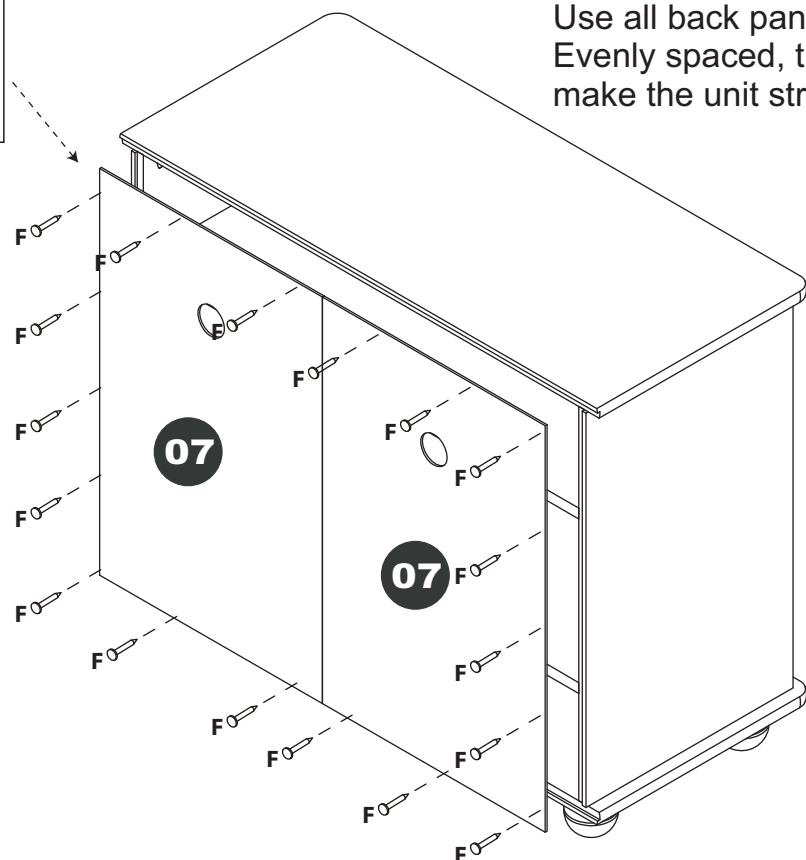

F=18



9

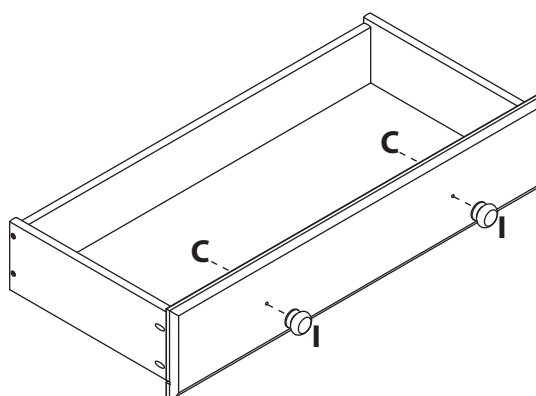
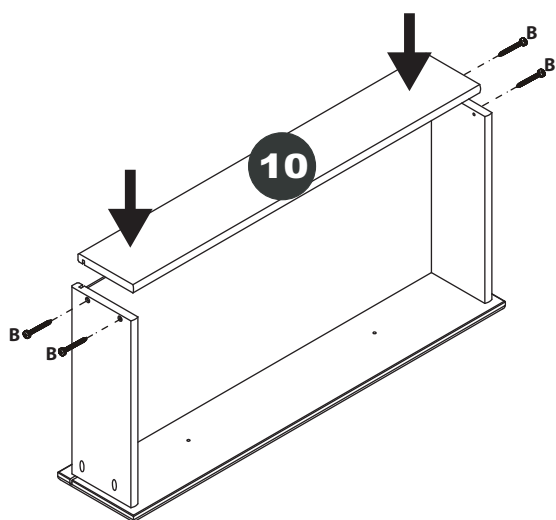
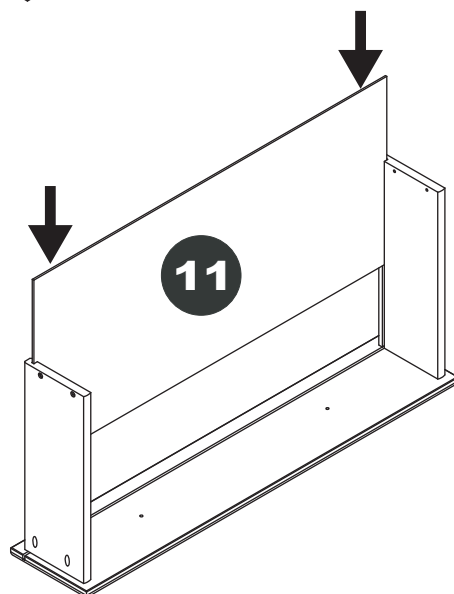
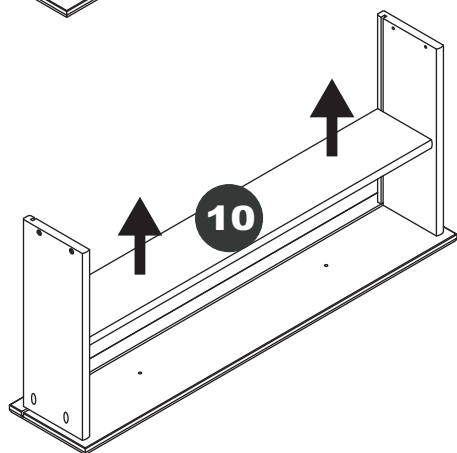
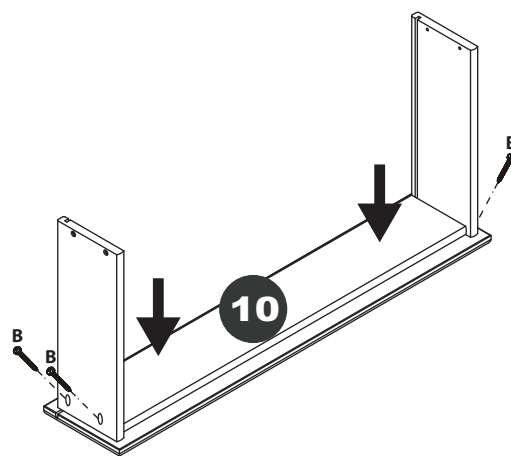
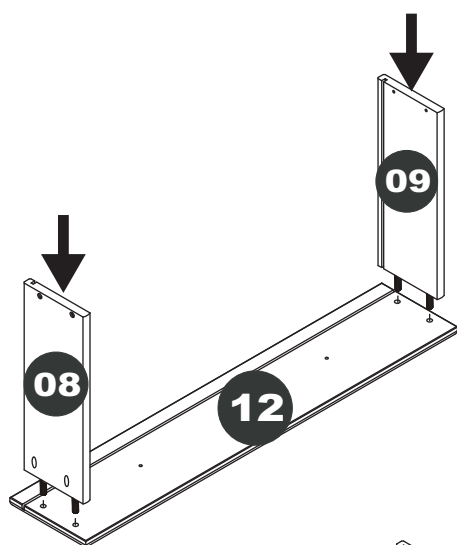

B=08



3,5 x 30mm

C=02

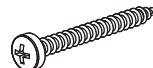

4,0 x 40mm

I=02



10

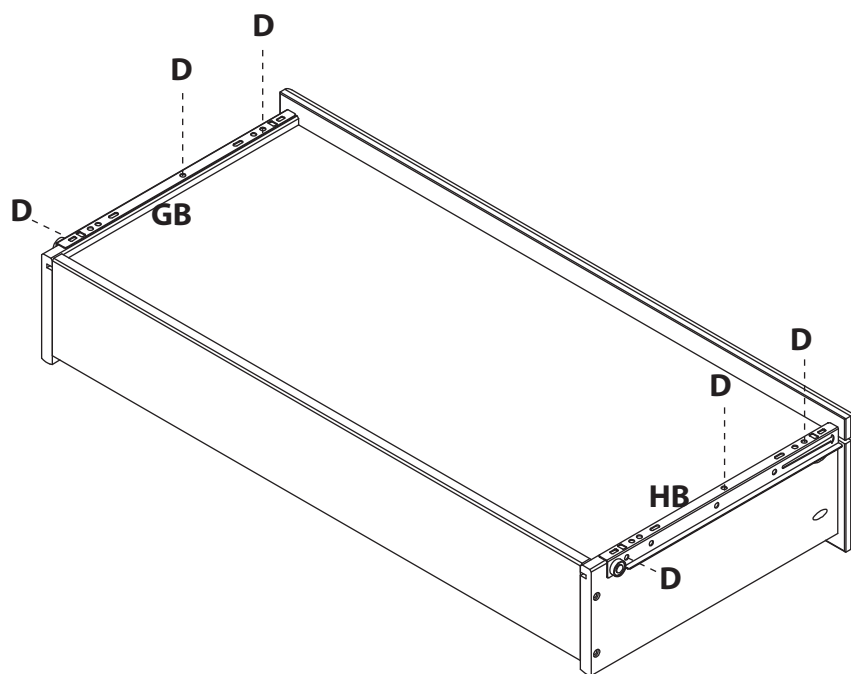

D=06



3,0x 16mm

G=01

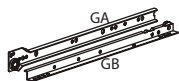

LEFT SET

H=01

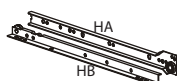

RIGHT SET

11

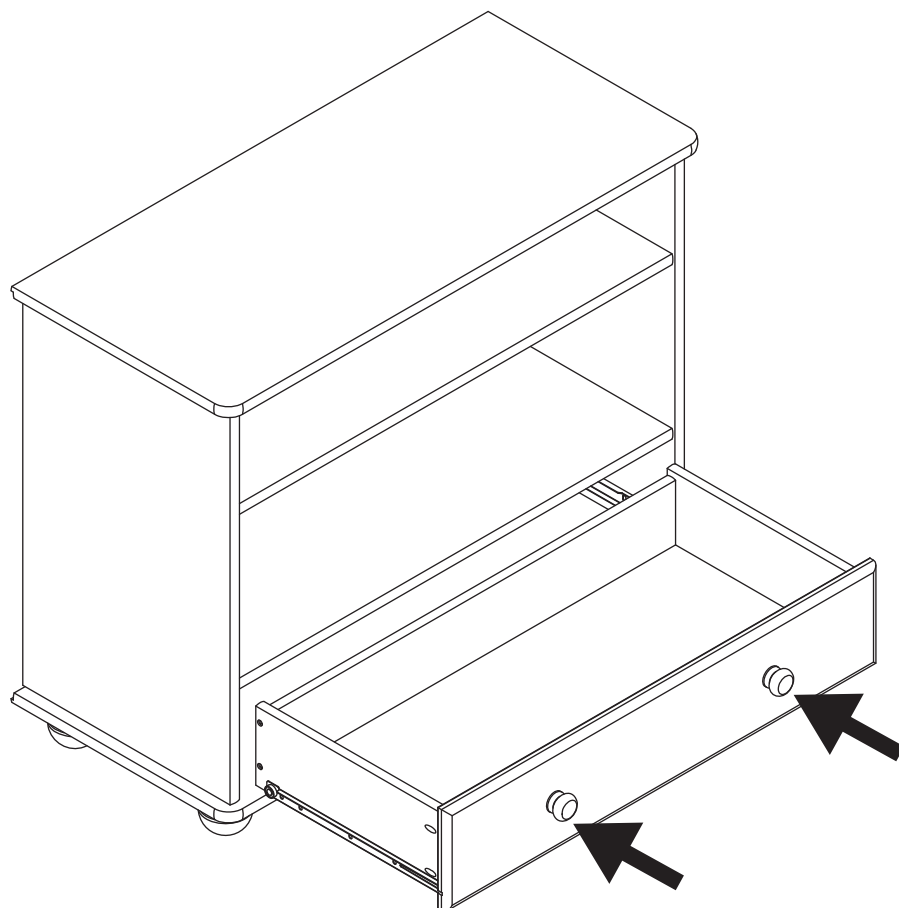

**COMPLETED ASSEMBLY:
THANK YOU FOR YOUR PURCHASE, AND WELCOME TO ADEPTUS!**

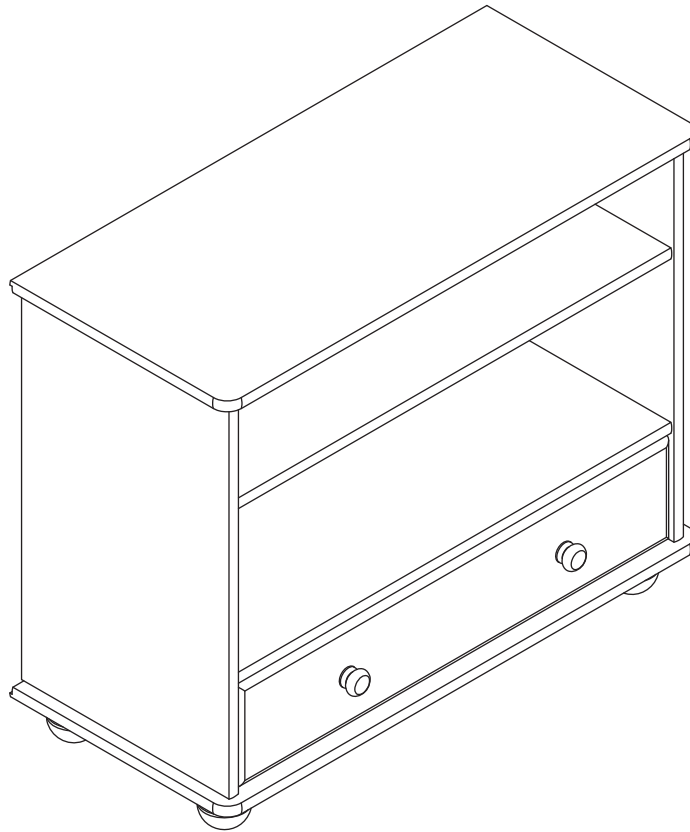

USE AND CARE INSTRUCTIONS:

CARE INSTRUCTIONS:

NORMAL USE: WIPE WITH A CLEAN CLOTH.

WHEN NEEDED TO CLEAN SCUFFS:WIPE CLEAN WITH A SLIGHTLY DAMP CLOTH AND A MILD CLEANER. THEN WIPE DRY WITH A CLEAN CLOTH.

IF YOU OIL OR WAX THIS FURNITURE, IT WILL MORE QUICKLY DEVELOP A PATINA AND DARKEN.